

STYLE TR ROD T-SEALS

T-Seals combine a resilient sealing ring with a hard, split back-up ring on each side of the sealing element. The assembly installs in a standard o-ring groove. T-Seals are non-spiraling and extrusion resistant to 5,000 psi with improved tolerances.

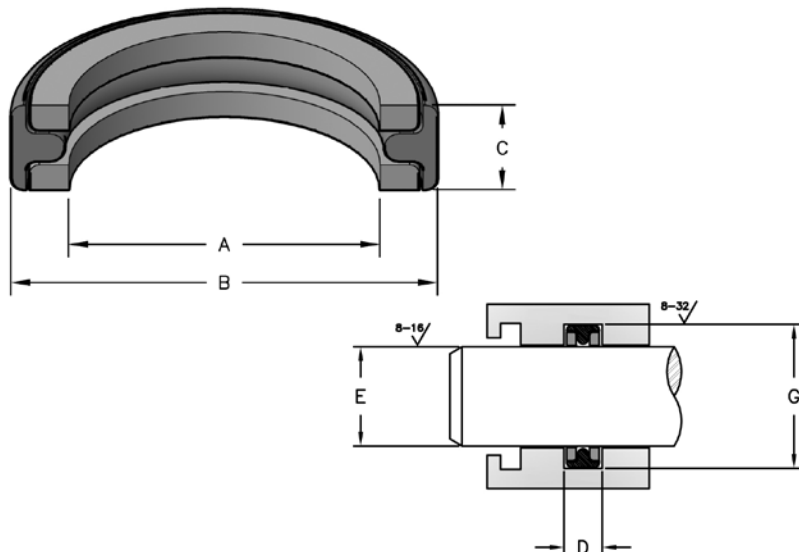

SEAL INFORMATION	
MATERIAL	BUNA-N RUBBER SEAL- HARD PLASTIC BACK-UPS
TEMPERATURE RANGE	-35° TO +220° F
PRESSURE RANGE	0 TO 5,000 PSI
SPEED	3 FT/SEC
PART NUMBER	(Prefix) - (Size)

Flurocarbon T-Seals can be manufactured on request!!

Part Number	A Nom. ID	B Nom. OD	C Nom. Ht	O-RING DASH NUMBER	D GROOVE WIDTH	E ROD DIAMETER	G HOUSING DIAMETER	List Price
TR-001	3/16	3/8	.15	-106	.150 ⁺⁰¹⁰ / ₊₀₀₀	.187 ⁺⁰⁰⁰ / ₋₀₀₂	.370 ±.002	\$7.18
TR-004	3/8	5/8	.185	-204	.185 ⁺⁰¹⁰ / ₊₀₀₀	.375 ⁻⁰⁰¹ / ₋₀₀₃	.618 ±.002	5.20
TR-006	1/2	3/4	.185	-206	.185 ⁺⁰¹⁰ / ₊₀₀₀	.500 ⁻⁰⁰¹ / ₋₀₀₃	.743 ±.002	8.79
TR-008	5/8	7/8	.185	-208	.185 ⁺⁰¹⁰ / ₊₀₀₀	.625 ⁻⁰⁰¹ / ₋₀₀₃	.868 ±.002	6.47
TR-009	11/16	15/16	.185	-209	.185 ⁺⁰¹⁰ / ₊₀₀₀	.687 ⁻⁰⁰¹ / ₋₀₀₃	.930 ±.002	6.49
TR-010	3/4	1	.185	-210	.185 ⁺⁰¹⁰ / ₊₀₀₀	.750 ⁻⁰⁰² / ₋₀₀₄	.992 ±.002	6.85
TR-012	7/8	1-1/8	.185	-212	.185 ⁺⁰¹⁰ / ₊₀₀₀	.875 ⁻⁰⁰² / ₋₀₀₄	1.117 ±.002	7.79
TR-014	1	1-1/4	.185	-214	.185 ⁺⁰¹⁰ / ₊₀₀₀	1.000 ⁻⁰⁰² / ₋₀₀₄	1.242 ±.002	6.85
TR-015	1-1/16	1-5/16	.185	-215	.185 ⁺⁰¹⁰ / ₊₀₀₀	1.062 ⁻⁰⁰² / ₋₀₀₄	1.304 ±.002	7.09
TR-016	1-1/8	1-3/8	.185	-216	.185 ⁺⁰¹⁰ / ₊₀₀₀	1.125 ⁻⁰⁰² / ₋₀₀₄	1.367 ±.002	7.79
TR-017	1-3/16	1-7/16	.185	-217	.185 ⁺⁰¹⁰ / ₊₀₀₀	1.187 ⁻⁰⁰² / ₋₀₀₄	1.429 ±.002	13.72
TR-018	1-1/4	1-1/2	.185	-218	.185 ⁺⁰¹⁰ / ₊₀₀₀	1.250 ⁻⁰⁰² / ₋₀₀₄	1.492 ±.002	7.00
TR-020	1-3/8	1-5/8	.185	-220	.185 ⁺⁰¹⁰ / ₊₀₀₀	1.375 ⁻⁰⁰² / ₋₀₀₄	1.617 ±.002	9.41
TR-022	1-1/2	1-3/4	.185	-222	.185 ⁺⁰¹⁰ / ₊₀₀₀	1.500 ⁻⁰⁰² / ₋₀₀₄	1.742 ±.002	7.79
TR-023	1-1/2	1-7/8	.28	-325	.280 ⁺⁰¹⁰ / ₊₀₀₀	1.500 ⁻⁰⁰² / ₋₀₀₄	1.871 ±.002	6.37
TR-024	1-5/8	2	.28	-326	.280 ⁺⁰¹⁰ / ₊₀₀₀	1.625 ⁻⁰⁰² / ₋₀₀₄	1.996 ±.002	9.62
TR-025	1-3/4	2-1/8	.28	-327	.280 ⁺⁰¹⁰ / ₊₀₀₀	1.750 ⁻⁰⁰² / ₋₀₀₄	2.121 ±.002	7.21

STYLE TR ROD T-SEALS



Part Number	A Nom. ID	B Nom. OD	C Nom. Ht	O-RING DASH NUMBER	D GROOVE WIDTH	E ROD DIAMETER	G HOUSING DIAMETER	List Price
TR-026	1-7/8	2-1/4	.28	-328	.280 ⁺⁰¹⁰ / ₊₀₀₀	1.875 ⁻⁰⁰² / ₋₀₀₄	2.246 ±002	9.94
TR-027	2	2-3/8	.28	-329	.280 ⁺⁰¹⁰ / ₊₀₀₀	2.000 ⁻⁰⁰² / ₋₀₀₄	2.371 ±002	8.03
TR-027-WB	2	2-3/8	.405	-329	.405 ⁺⁰¹⁰ / ₊₀₀₀	2.000 ⁻⁰⁰² / ₋₀₀₄	2.371 ±002	17.45
TR-028	2-1/8	2-1/2	.28	-330	.280 ⁺⁰¹⁰ / ₊₀₀₀	2.125 ⁻⁰⁰² / ₋₀₀₄	2.496 ±002	8.50
TR-029	2-1/4	2-5/8	.28	-331	.280 ⁺⁰¹⁰ / ₊₀₀₀	2.250 ⁻⁰⁰² / ₋₀₀₄	2.613 ±002	9.48
TR-030	2-3/8	2-3/4	.28	-332	.280 ⁺⁰¹⁰ / ₊₀₀₀	2.375 ⁻⁰⁰¹ / ₋₀₀₅	2.746 ⁺⁰⁰¹ / ₋₀₀₃	9.87
TR-031	2-1/2	2-7/8	.28	-333	.280 ⁺⁰¹⁰ / ₊₀₀₀	2.500 ⁻⁰⁰¹ / ₋₀₀₅	2.871 ⁺⁰⁰¹ / ₋₀₀₃	9.97
TR-032	2-5/8	3	.28	-334	.280 ⁺⁰¹⁰ / ₊₀₀₀	2.625 ⁻⁰⁰¹ / ₋₀₀₅	2.996 ⁺⁰⁰¹ / ₋₀₀₃	10.00
TR-033	2-3/4	3-1/8	.28	-335	.280 ⁺⁰¹⁰ / ₊₀₀₀	2.750 ⁻⁰⁰¹ / ₋₀₀₅	3.121 ⁺⁰⁰¹ / ₋₀₀₃	11.36
TR-034	2-7/8	3-1/4	.28	-336	.280 ⁺⁰¹⁰ / ₊₀₀₀	2.875 ⁻⁰⁰¹ / ₋₀₀₅	3.246 ⁺⁰⁰¹ / ₋₀₀₃	11.67
TR-035	3	3-3/8	.28	-337	.280 ⁺⁰¹⁰ / ₊₀₀₀	3.000 ⁻⁰⁰² / ₋₀₀₆	3.370 ⁺⁰⁰¹ / ₋₀₀₃	12.20
TR-036	3-1/8	3-1/2	.28	-338	.280 ⁺⁰¹⁰ / ₊₀₀₀	3.125 ⁻⁰⁰² / ₋₀₀₆	3.495 ⁺⁰⁰¹ / ₋₀₀₃	13.06
TR-037	3-1/4	3-5/8	.28	-339	.280 ⁺⁰¹⁰ / ₊₀₀₀	3.250 ⁻⁰⁰² / ₋₀₀₆	3.620 ⁺⁰⁰¹ / ₋₀₀₃	13.95
TR-038	3-3/8	3-3/4	.28	-340	.280 ⁺⁰¹⁰ / ₊₀₀₀	3.375 ⁻⁰⁰² / ₋₀₀₆	3.745 ⁺⁰⁰¹ / ₋₀₀₃	14.46
TR-039	3-1/2	3-7/8	.28	-341	.280 ⁺⁰¹⁰ / ₊₀₀₀	3.500 ⁻⁰⁰² / ₋₀₀₆	3.870 ⁺⁰⁰¹ / ₋₀₀₃	15.50
TR-040	3-5/8	4	.28	-342	.280 ⁺⁰¹⁰ / ₊₀₀₀	3.625 ⁻⁰⁰² / ₋₀₀₆	3.995 ⁺⁰⁰¹ / ₋₀₀₃	16.23
TR-041	3-3/4	4-1/8	.28	-343	.280 ⁺⁰¹⁰ / ₊₀₀₀	3.750 ⁻⁰⁰² / ₋₀₀₆	4.120 ⁺⁰⁰¹ / ₋₀₀₃	17.19
TR-042	3-7/8	4-1/4	.28	-344	.280 ⁺⁰¹⁰ / ₊₀₀₀	3.875 ⁻⁰⁰² / ₋₀₀₆	4.245 ⁺⁰⁰¹ / ₋₀₀₃	17.74
TR-043	4	4-3/8	.28	-345	.280 ⁺⁰¹⁰ / ₊₀₀₀	4.000 ⁻⁰⁰² / ₋₀₀₆	4.370 ⁺⁰⁰¹ / ₋₀₀₃	18.85
TR-045	4-1/4	4-5/8	.28	-347	.280 ⁺⁰¹⁰ / ₊₀₀₀	4.250 ⁻⁰⁰² / ₋₀₀₆	4.620 ⁺⁰⁰¹ / ₋₀₀₃	20.52
TR-046	4-3/8	4-3/4	.28	-348	.280 ⁺⁰¹⁰ / ₊₀₀₀	4.375 ⁻⁰⁰² / ₋₀₀₆	4.745 ⁺⁰⁰¹ / ₋₀₀₃	23.31
TR-047	4-1/2	4-7/8	.28	-349	.280 ⁺⁰¹⁰ / ₊₀₀₀	4.500 ⁻⁰⁰² / ₋₀₀₆	4.870 ⁺⁰⁰¹ / ₋₀₀₃	23.32
TR-048	5	5-1/2	.366	-429	.366 ⁺⁰¹⁰ / ₊₀₀₀	5.000 ⁻⁰⁰² / ₋₀₀₆	5.475 ⁺⁰⁰¹ / ₋₀₀₃	29.39
TR-049	5-1/4	5-3/4	.366	-431	.366 ⁺⁰¹⁰ / ₊₀₀₀	5.250 ⁻⁰⁰² / ₋₀₀₆	5.725 ⁺⁰⁰¹ / ₋₀₀₃	37.58
TR-050	5-1/2	6	.366	-433	.366 ⁺⁰¹⁰ / ₊₀₀₀	5.500 ⁻⁰⁰² / ₋₀₀₆	5.975 ⁺⁰⁰¹ / ₋₀₀₃	63.10
TR-052	6	6-1/2	.366	-437	.366 ⁺⁰¹⁰ / ₊₀₀₀	6.000 ⁻⁰⁰¹ / ₋₀₀₇	6.475 ⁺⁰⁰² / ₋₀₀₄	37.19
TR-054	6-1/2	7	.366	-439	.366 ⁺⁰¹⁰ / ₊₀₀₀	6.500 ⁻⁰⁰¹ / ₋₀₀₇	6.975 ⁺⁰⁰² / ₋₀₀₄	63.14
TR-056	7	7-1/2	.366	-441	.366 ⁺⁰¹⁰ / ₊₀₀₀	7.000 ⁻⁰⁰¹ / ₋₀₀₇	7.475 ⁺⁰⁰² / ₋₀₀₄	54.43
TR-058	7-1/2	8	.366	-443	.366 ⁺⁰¹⁰ / ₊₀₀₀	7.500 ⁻⁰⁰¹ / ₋₀₀₇	7.984 ⁺⁰⁰² / ₋₀₀₄	67.03
TR-059	8	8-1/2	.366	-445	.366 ⁺⁰¹⁰ / ₊₀₀₀	8.000 ⁻⁰⁰¹ / ₋₀₀₇	8.475 ⁺⁰⁰² / ₋₀₀₄	101.03



STYLE TR ROD T-SEALS

Part Number	A Nom. ID	B Nom. OD	C Nom. Ht	O-RING DASH NUMBER	D GROOVE WIDTH	E ROD DIAMETER	G HOUSING DIAMETER	List Price
TR-060	9	9-1/2	.366	-447	.366 ⁺⁰¹⁰ / ₊₀₀₀	9.000 ⁻⁰⁰¹ / _{-.007}	9.475 ⁺⁰⁰² / _{-.004}	116.79

Seal color may vary. Special order sizes are available. Sizes not shown and out of stock items can also be ordered for next day delivery through Seals On Demand, our custom seal program. Please call your regional sales team for assistance.



**Custom Hoists,
Parker/Commercial, SHC
Telescopic Cylinders, Tie-
Rod and Welded Cylinders
are available!!!**

STYLE TP PISTON T-SEALS



T-Seals combine a resilient sealing ring with a hard, split back-up ring on each side of the sealing element. The assembly installs in a standard o-ring groove. T-Seals are non-spiraling and extrusion resistant to 5,000 psi with improved tolerances. Intermediate and Wide Base T-Seals are designed to fit MIL-5514F o-ring glands only and interchange with 1 o-ring / 1 back-up ring and 1 o-ring / 2 back-up ring grooves, respectively.

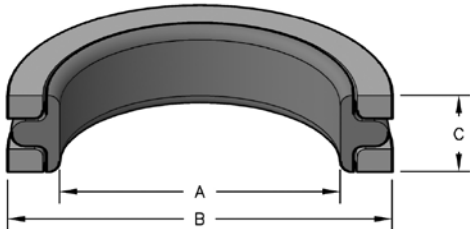

IB = Intermediate Base
WB = Wide Base

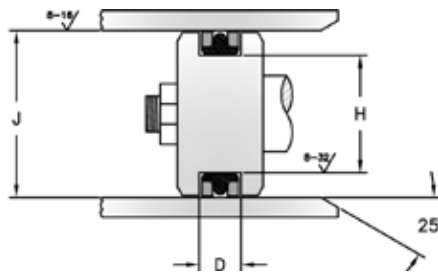

SEAL INFORMATION	
MATERIAL	BUNA-N RUBBER SEAL-HARD PLASTIC BACK-UPS
TEMPERATURE RANGE	-35° TO +220° F
PRESSURE RANGE	0 TO 5,000 PSI
SPEED	3 FT/SEC
PART NUMBER	(Prefix) - (Size)

Intermediate and Wide Base T-Seals are designed to fit MIL-5514F o-ring glands only and interchange with 1 o-ring / 1 back-up ring and 1 o-ring / 2 back-up ring grooves, respectively.

Flourocarbon T-Seals can manufactured on request!!

Part Number	A Nom. ID	B Nom. OD	C Nom. Ht	O-RING DASH NUMBER	D GROOVE WIDTH	H GROOVE DIAMETER	J BORE DIAMETER	List Price
TP-007	1/2	3/4	.185	-206	.185 ⁺⁰¹⁰ / ₊₀₀₀	.505 ⁺⁰⁰² / ₊₀₀₀	.750 ±.001	\$ 7.70
TP-009	5/8	7/8	.185	-208	.185 ⁺⁰¹⁰ / ₊₀₀₀	.630 ⁺⁰⁰² / ₊₀₀₀	.875 ±.001	6.61
TP-011	3/4	1	.185	-210	.185 ⁺⁰¹⁰ / ₊₀₀₀	.756 ⁺⁰⁰² / ₊₀₀₀	1.000 ⁺⁰⁰² / ₊₀₀₀	7.37
TP-012	13/16	1-1/16	.185	-211	.185 ⁺⁰¹⁰ / ₊₀₀₀	.818 ⁺⁰⁰² / ₊₀₀₀	1.063 ⁺⁰⁰² / ₊₀₀₀	8.95
TP-013	7/8	1-1/8	.185	-212	.185 ⁺⁰¹⁰ / ₊₀₀₀	.881 ⁺⁰⁰² / ₊₀₀₀	1.125 ⁺⁰⁰² / ₊₀₀₀	6.85
TP-014	15/16	1-3/16	.185	-213	.185 ⁺⁰¹⁰ / ₊₀₀₀	.943 ⁺⁰⁰² / ₊₀₀₀	1.188 ⁺⁰⁰² / ₊₀₀₀	8.95
TP-015	1	1-1/4	.185	-214	.185 ⁺⁰¹⁰ / ₊₀₀₀	1.006 ⁺⁰⁰² / ₊₀₀₀	1.250 ⁺⁰⁰² / ₊₀₀₀	7.79
TP-016	1-1/16	1-5/16	.185	-215	.185 ⁺⁰¹⁰ / ₊₀₀₀	1.068 ⁺⁰⁰² / ₊₀₀₀	1.313 ⁺⁰⁰² / ₊₀₀₀	6.85
TP-017	1-1/8	1-3/8	.185	-216	.185 ⁺⁰¹⁰ / ₊₀₀₀	1.131 ⁺⁰⁰² / ₊₀₀₀	1.375 ⁺⁰⁰² / ₊₀₀₀	6.85
TP-018	1-3/16	1-7/16	.185	-217	.185 ⁺⁰¹⁰ / ₊₀₀₀	1.193 ⁺⁰⁰² / ₊₀₀₀	1.438 ⁺⁰⁰² / ₊₀₀₀	8.95
TP-019	1-1/4	1-1/2	.185	-218	.185 ⁺⁰¹⁰ / ₊₀₀₀	1.256 ⁺⁰⁰² / ₊₀₀₀	1.500 ⁺⁰⁰² / ₊₀₀₀	6.09
TP-218-WB	1-1/4	1-1/2	.304	-218	.304 ⁺⁰¹⁰ / ₊₀₀₀	1.256 ⁺⁰⁰² / ₊₀₀₀	1.500 ⁺⁰⁰² / ₊₀₀₀	11.52
TP-021	1-3/8	1-5/8	.185	-220	.185 ⁺⁰¹⁰ / ₊₀₀₀	1.381 ⁺⁰⁰² / ₊₀₀₀	1.625 ⁺⁰⁰² / ₊₀₀₀	7.79
TP-221	1-7/16	1-11/16	.185	-221	.185 ⁺⁰¹⁰ / ₊₀₀₀	1.442 ⁺⁰⁰² / ₊₀₀₀	1.688 ⁺⁰⁰² / ₊₀₀₀	6.85
TP-022	1-1/2	1-3/4	.185	-222	.185 ⁺⁰¹⁰ / ₊₀₀₀	1.506 ⁺⁰⁰² / ₊₀₀₀	1.750 ⁺⁰⁰² / ₊₀₀₀	6.58
TP-222-IB	1-1/2	1-3/4	.235	-222	.235 ⁺⁰¹⁰ / ₊₀₀₀	1.506 ⁺⁰⁰² / ₊₀₀₀	1.750 ⁺⁰⁰² / ₊₀₀₀	16.23

STYLE TP PISTON T-SEALS

Part Number	A Nom. ID	B Nom. OD	C Nom. Ht	O-RING DASH NUMBER	D GROOVE WIDTH	H GROOVE DIAMETER	J BORE DIAMETER	List Price
TP-023	1-1/2	1-7/8	.28	-325	.280 ^{+0.010} / _{+0.000}	1.502 ^{+0.002} / _{+0.000}	1.875 ^{+0.002} / _{+0.000}	8.95
TP-024	1-5/8	2	.28	-326	.280 ^{+0.010} / _{+0.000}	1.627 ^{+0.002} / _{+0.000}	2.000 ^{+0.002} / _{+0.000}	6.87
TP-326-IB	1-5/8	2	.334	-326	.334 ^{+0.010} / _{+0.000}	1.627 ^{+0.002} / _{+0.000}	2.000 ^{+0.002} / _{+0.000}	16.23
TP-025	1-3/4	2-1/8	.28	-327	.280 ^{+0.010} / _{+0.000}	1.752 ^{+0.002} / _{+0.000}	2.125 ^{+0.002} / _{+0.000}	7.21
TP-026	1-7/8	2-1/4	.28	-328	.280 ^{+0.010} / _{+0.000}	1.877 ^{+0.002} / _{+0.000}	2.250 ^{+0.002} / _{+0.000}	7.66
TP-328-IB	1-7/8	2-1/4	.334	-328	.334 ^{+0.010} / _{+0.000}	1.877 ^{+0.002} / _{+0.000}	2.250 ^{+0.002} / _{+0.000}	17.32
TP-328-WB	1-7/8	2-1/4	.424	-328	.424 ^{+0.010} / _{+0.000}	1.877 ^{+0.002} / _{+0.000}	2.250 ^{+0.002} / _{+0.000}	18.38
TP-027	2	2-3/8	.28	-329	.280 ^{+0.010} / _{+0.000}	2.002 ^{+0.002} / _{+0.000}	2.375 ^{+0.002} / _{+0.000}	8.03
TP-028	2-1/8	2-1/2	.28	-330	.280 ^{+0.010} / _{+0.000}	2.127 ^{+0.002} / _{+0.000}	2.500 ^{+0.002} / _{+0.000}	8.50
TP-330-IB	2-1/8	2-1/2	.334	-330	.334 ^{+0.010} / _{+0.000}	2.127 ^{+0.002} / _{+0.000}	2.500 ^{+0.002} / _{+0.000}	17.75
TP-330-WB	2-1/8	2-1/2	.424	-330	.424 ^{+0.010} / _{+0.000}	2.127 ^{+0.002} / _{+0.000}	2.500 ^{+0.002} / _{+0.000}	19.39
TP-029	2-1/4	2-5/8	.28	-331	.280 ^{+0.010} / _{+0.000}	2.252 ^{+0.002} / _{+0.000}	2.625 ^{+0.002} / _{+0.000}	9.22
TP-030	2-3/8	2-3/4	.28	-332	.280 ^{+0.010} / _{+0.000}	2.377 ^{+0.003} / _{-0.001}	2.750 ^{+0.003} / _{-0.001}	9.35
TP-031	2-1/2	2-7/8	.28	-333	.280 ^{+0.010} / _{+0.000}	2.502 ^{+0.003} / _{-0.001}	2.875 ^{+0.003} / _{-0.001}	9.68
TP-333-WB	2-1/2	2-7/8	.424	-333	.424 ^{+0.010} / _{+0.000}	2.502 ^{+0.003} / _{-0.001}	2.875 ^{+0.003} / _{-0.001}	26.50
TP-032	2-5/8	3	.28	-334	.280 ^{+0.010} / _{+0.000}	2.627 ^{+0.003} / _{-0.001}	3.000 ^{+0.003} / _{-0.001}	10.04
TP-334-IB	2-5/8	3	.334	-334	.334 ^{+0.010} / _{+0.000}	2.627 ^{+0.003} / _{-0.001}	3.000 ^{+0.003} / _{-0.001}	28.38
TP-334-WB	2-5/8	3	.424	-334	.424 ^{+0.010} / _{+0.000}	2.627 ^{+0.003} / _{-0.001}	3.000 ^{+0.003} / _{-0.001}	29.82
TP-033	2-3/4	3-1/8	.28	-335	.280 ^{+0.010} / _{+0.000}	2.752 ^{+0.003} / _{-0.001}	3.125 ^{+0.003} / _{-0.001}	10.47
TP-034	2-7/8	3-1/4	.28	-336	.280 ^{+0.010} / _{+0.000}	2.877 ^{+0.003} / _{-0.001}	3.250 ^{+0.003} / _{-0.001}	11.67
TP-035	3-1/8	3-1/2	.28	-338	.280 ^{+0.010} / _{+0.000}	3.128 ^{+0.003} / _{-0.001}	3.500 ^{+0.004} / _{+0.000}	12.77
TP-338-IB	3-1/8	3-1/2	.334	-338	.334 ^{+0.010} / _{+0.000}	3.128 ^{+0.003} / _{-0.001}	3.500 ^{+0.004} / _{+0.000}	29.58
TP-338-WB	3-1/8	3-1/2	.424	-338	.424 ^{+0.010} / _{+0.000}	3.128 ^{+0.003} / _{-0.001}	3.500 ^{+0.004} / _{+0.000}	32.24
TP-036	3-1/4	3-5/8	.28	-339	.280 ^{+0.010} / _{+0.000}	3.253 ^{+0.003} / _{-0.001}	3.625 ^{+0.004} / _{+0.000}	13.90
TP-037	3-3/8	3-3/4	.28	-340	.280 ^{+0.010} / _{+0.000}	3.378 ^{+0.003} / _{-0.001}	3.750 ^{+0.004} / _{+0.000}	14.46
TP-038	3-1/2	3-7/8	.28	-341	.280 ^{+0.010} / _{+0.000}	3.503 ^{+0.003} / _{-0.001}	3.875 ^{+0.004} / _{+0.000}	18.69
TP-039	3-5/8	4	.28	-342	.280 ^{+0.010} / _{+0.000}	3.628 ^{+0.003} / _{-0.001}	4.000 ^{+0.004} / _{+0.000}	16.10
TP-342-WB	3-5/8	4	.424	-342	.424 ^{+0.010} / _{+0.000}	3.628 ^{+0.003} / _{-0.001}	4.000 ^{+0.004} / _{+0.000}	38.05
TP-040	3-3/4	4-1/8	.28	-343	.280 ^{+0.010} / _{+0.000}	3.753 ^{+0.003} / _{-0.001}	4.125 ^{+0.004} / _{+0.000}	26.12
TP-041	3-7/8	4-1/4	.28	-344	.280 ^{+0.010} / _{+0.000}	3.878 ^{+0.003} / _{-0.001}	4.250 ^{+0.004} / _{+0.000}	18.54

STYLE TP PISTON T-SEALS



Part Number	A Nom. ID	B Nom. OD	C Nom. Ht	O-RING DASH NUMBER	D GROOVE WIDTH	H GROOVE DIAMETER	J BORE DIAMETER	List Price
TP-042	4	4-3/8	.28	-345	.280 ⁺⁰¹⁰ / ₊₀₀₀	4.003 ⁺⁰⁰³ / _{-.001}	4.375 ⁺⁰⁰⁴ / ₊₀₀₀	19.63
TP-043	4-1/8	4-1/2	.28	-346	.280 ⁺⁰¹⁰ / ₊₀₀₀	4.128 ⁺⁰⁰³ / _{-.001}	4.500 ⁺⁰⁰⁴ / ₊₀₀₀	20.01
TP-346-IB	4-1/8	4-1/2	.334	-346	.334 ⁺⁰¹⁰ / ₊₀₀₀	4.128 ⁺⁰⁰³ / _{-.001}	4.500 ⁺⁰⁰⁴ / ₊₀₀₀	56.73
TP-346-WB	4-1/8	4-1/2	.424	-346	.424 ⁺⁰¹⁰ / ₊₀₀₀	4.128 ⁺⁰⁰³ / _{-.001}	4.500 ⁺⁰⁰⁴ / ₊₀₀₀	46.06
TP-044	4-1/4	4-5/8	.28	-347	.280 ⁺⁰¹⁰ / ₊₀₀₀	4.253 ⁺⁰⁰³ / _{-.001}	4.625 ⁺⁰⁰⁴ / ₊₀₀₀	24.80
TP-347-IB	4-1/4	4-5/8	.334	-347	.334 ⁺⁰¹⁰ / ₊₀₀₀	4.253 ⁺⁰⁰³ / _{-.001}	4.625 ⁺⁰⁰⁴ / ₊₀₀₀	54.25
TP-045	4-3/8	4-3/4	.28	-348	.280 ⁺⁰¹⁰ / ₊₀₀₀	4.378 ⁺⁰⁰³ / _{-.001}	4.750 ⁺⁰⁰⁴ / ₊₀₀₀	27.92
TP-046	4-1/2	4-7/8	.28	-349	.280 ⁺⁰¹⁰ / ₊₀₀₀	4.503 ⁺⁰⁰³ / _{-.001}	4.875 ⁺⁰⁰⁴ / ₊₀₀₀	28.09
TP-047	4-5/8	5	.28	-350	.280 ⁺⁰¹⁰ / ₊₀₀₀	4.629 ⁺⁰⁰³ / _{-.001}	5.000 ⁺⁰⁰⁵ / ₊₀₀₁	29.18
TP-350-WB	4-5/8	5	.424	-350	.424 ⁺⁰¹⁰ / ₊₀₀₀	4.629 ⁺⁰⁰³ / _{-.001}	5.000 ⁺⁰⁰⁵ / ₊₀₀₁	59.11
TP-425-IB	4-1/2	5	.475	-425	.475 ⁺⁰¹⁰ / ₊₀₀₀	4.524 ⁺⁰⁰³ / _{-.001}	5.000 ⁺⁰⁰⁵ / ₊₀₀₁	64.88
TP-425-WB	4-1/2	5	.579	-425	.579 ⁺⁰¹⁰ / ₊₀₀₀	4.524 ⁺⁰⁰³ / _{-.001}	5.000 ⁺⁰⁰⁵ / ₊₀₀₁	79.75
TP-048	4-5/8	5-1/8	.366	-426	.366 ⁺⁰¹⁰ / ₊₀₀₀	4.649 ⁺⁰⁰³ / _{-.001}	5.125 ⁺⁰⁰⁵ / ₊₀₀₁	34.90
TP-049	4-3/4	5-1/4	.366	-427	.366 ⁺⁰¹⁰ / ₊₀₀₀	4.774 ⁺⁰⁰³ / _{-.001}	5.250 ⁺⁰⁰⁵ / ₊₀₀₁	31.96
TP-427-WB	4-3/4	5-1/4	.579	-427	.579 ⁺⁰¹⁰ / ₊₀₀₀	4.774 ⁺⁰⁰³ / _{-.001}	5.250 ⁺⁰⁰⁵ / ₊₀₀₁	65.03
TP-051	5	5-1/2	.366	-429	.366 ⁺⁰¹⁰ / ₊₀₀₀	5.024 ⁺⁰⁰³ / _{-.001}	5.500 ⁺⁰⁰⁵ / ₊₀₀₁	35.11
TP-429-IB	5	5-1/2	.475	-429	.475 ⁺⁰¹⁰ / ₊₀₀₀	5.024 ⁺⁰⁰³ / _{-.001}	5.500 ⁺⁰⁰⁵ / ₊₀₀₁	65.67
TP-053	5-1/4	5-3/4	.366	-431	.366 ⁺⁰¹⁰ / ₊₀₀₀	5.274 ⁺⁰⁰³ / _{-.001}	5.750 ⁺⁰⁰⁵ / ₊₀₀₁	35.87
TP-054	5-3/8	5-7/8	.366	-432	.366 ⁺⁰¹⁰ / ₊₀₀₀	5.399 ⁺⁰⁰³ / _{-.001}	5.875 ⁺⁰⁰⁵ / ₊₀₀₁	36.74
TP-055	5-1/2	6	.366	-433	.366 ⁺⁰¹⁰ / ₊₀₀₀	5.524 ⁺⁰⁰³ / _{-.001}	6.000 ⁺⁰⁰⁵ / ₊₀₀₁	38.74
TP-433-IB	5-1/2	6	.475	-433	.475 ⁺⁰¹⁰ / ₊₀₀₀	5.524 ⁺⁰⁰³ / _{-.001}	6.000 ⁺⁰⁰⁵ / ₊₀₀₁	75.19
TP-433-WB	5-1/2	6	.579	-433	.579 ⁺⁰¹⁰ / ₊₀₀₀	5.524 ⁺⁰⁰³ / _{-.001}	6.000 ⁺⁰⁰⁵ / ₊₀₀₁	83.63
TP-057	5-3/4	6-1/4	.366	-435	.366 ⁺⁰¹⁰ / ₊₀₀₀	5.774 ⁺⁰⁰³ / _{-.001}	6.250 ⁺⁰⁰⁵ / ₊₀₀₁	39.83
TP-435-IB	5-3/4	6-1/4	.475	-435	.475 ⁺⁰¹⁰ / ₊₀₀₀	5.774 ⁺⁰⁰³ / _{-.001}	6.250 ⁺⁰⁰⁵ / ₊₀₀₁	85.45
TP-058	6	6-1/2	.366	-437	.366 ⁺⁰¹⁰ / ₊₀₀₀	6.024 ⁺⁰⁰⁴ / _{-.002}	6.500 ⁺⁰⁰⁶ / ₊₀₀₀	39.92
TP-060	6-1/2	7	.366	-439	.366 ⁺⁰¹⁰ / ₊₀₀₀	6.524 ⁺⁰⁰⁴ / _{-.002}	7.000 ⁺⁰⁰⁶ / ₊₀₀₀	46.36
TP-439-IB	6-1/2	7	.475	-439	.475 ⁺⁰¹⁰ / ₊₀₀₀	6.524 ⁺⁰⁰⁴ / _{-.002}	7.000 ⁺⁰⁰⁶ / ₊₀₀₀	88.48
TP-439-WB	6-1/2	7	.579	-439	.579 ⁺⁰¹⁰ / ₊₀₀₀	6.524 ⁺⁰⁰⁴ / _{-.002}	7.000 ⁺⁰⁰⁶ / ₊₀₀₀	96.49
TP-061	6-3/4	7-1/4	.366	-440	.366 ⁺⁰¹⁰ / ₊₀₀₀	6.774 ⁺⁰⁰⁴ / _{-.002}	7.250 ⁺⁰⁰⁶ / ₊₀₀₀	69.50
TP-062	7	7-1/2	.366	-441	.366 ⁺⁰¹⁰ / ₊₀₀₀	7.024 ⁺⁰⁰⁴ / _{-.002}	7.500 ⁺⁰⁰⁶ / ₊₀₀₀	50.66



STYLE TP PISTON T-SEALS

Part Number	A Nom. ID	B Nom. OD	C Nom. Ht	O-RING DASH NUMBER	D GROOVE WIDTH	H GROOVE DIAMETER	J BORE DIAMETER	List Price
TP-064	7-1/2	8	.366	-443	.366 ^{+0.010} / _{+0.000}	7.524 ^{+0.004} / _{-0.002}	8.000 ^{+0.006} / _{+0.000}	59.04
TP-443-WB	7-1/2	8	.579	-443	.579 ^{+0.010} / _{+0.000}	7.524 ^{+0.004} / _{-0.002}	8.000 ^{+0.006} / _{+0.000}	102.00
TP-065	7-3/4	8-1/4	.366	-444	.366 ^{+0.010} / _{+0.000}	7.774 ^{+0.004} / _{-0.002}	8.250 ^{+0.006} / _{+0.000}	63.08
TP-444-IB	7-3/4	8-1/4	.475	-444	.475 ^{+0.010} / _{+0.000}	7.774 ^{+0.004} / _{-0.002}	8.250 ^{+0.006} / _{+0.000}	109.83
TP-066	8	8-1/2	.366	-445	.366 ^{+0.010} / _{+0.000}	8.024 ^{+0.004} / _{-0.002}	8.500 ^{+0.006} / _{+0.000}	81.34
TP-067	8-1/2	9	.366	-446	.366 ^{+0.010} / _{+0.000}	8.524 ^{+0.004} / _{-0.002}	9.000 ^{+0.006} / _{+0.000}	74.44
TP-446-IB	8-1/2	9	.475	-446	.475 ^{+0.010} / _{+0.000}	8.524 ^{+0.004} / _{-0.002}	9.000 ^{+0.006} / _{+0.000}	126.97
TP-068	9	9-1/2	.366	-447	.366 ^{+0.010} / _{+0.000}	9.024 ^{+0.004} / _{-0.002}	9.500 ^{+0.006} / _{+0.000}	84.35
TP-069	9-1/2	10	.366	-448	.366 ^{+0.010} / _{+0.000}	9.524 ^{+0.004} / _{-0.002}	10.000 ^{+0.006} / _{+0.000}	86.08
TP-448-IB	9-1/2	10	.475	-448	.475 ^{+0.010} / _{+0.000}	9.524 ^{+0.004} / _{-0.002}	10.000 ^{+0.006} / _{+0.000}	149.39
TP-070	10	10-1/2	.366	-449	.366 ^{+0.010} / _{+0.000}	10.024 ^{+0.004} / _{-0.002}	10.500 ^{+0.006} / _{+0.000}	101.76
TP-071	10-1/2	11	.366	-450	.366 ^{+0.010} / _{+0.000}	10.524 ^{+0.004} / _{-0.002}	11.000 ^{+0.006} / _{+0.000}	112.94
TP-450-IB	10-1/2	11	.475	-450	.475 ^{+0.010} / _{+0.000}	10.524 ^{+0.004} / _{-0.002}	11.000 ^{+0.006} / _{+0.000}	175.76
TP-072	11	11-1/2	.366	-451	.366 ^{+0.010} / _{+0.000}	11.024 ^{+0.004} / _{-0.002}	11.500 ^{+0.006} / _{+0.000}	129.11
TP-073	11-1/2	12	.366	-452	.366 ^{+0.010} / _{+0.000}	11.524 ^{+0.004} / _{-0.002}	12.000 ^{+0.006} / _{+0.000}	137.90

Seal color may vary.

STYLE TP-L LOCKING PISTON T-SEALS



The Style TP-L seal is a zero drift piston seal for bi-directional pressure applications. The locking anti-extrusion rings provide for an easier installation. It is designed to retrofit O-Ring and standard T-seal grooves. The 70 Shore A NBR is designed specifically for performance in compression type dynamic seals. Other features include a net molded dynamic sealing surface and backup chamfers.

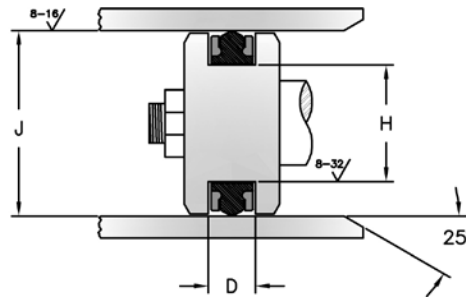
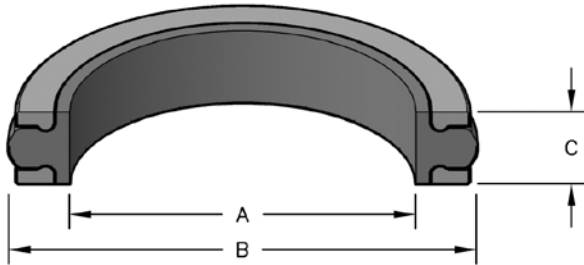

SEAL INFORMATION	
MATERIAL	BUNA-N RUBBER SEAL-HARD PLASTIC BACK-UPS
TEMPERATURE RANGE	-35° TO +220° F
PRESSURE RANGE	0 TO 5,000 PSI
SPEED	3 FT/SEC
PART NUMBER	(Prefix) - (Size)

Fluorocarbon T-Seals can be manufactured on request!!

Part Number	A Nom. ID	B Nom. OD	C Nom. Ht	O-RING DASH NUMBER	D GROOVE WIDTH	H GROOVE DIAMETER	J BORE DIAMETER	List Price
TP-009-L	5/8	7/8	.185	-208	.185 ⁺⁰¹⁰ / ₊₀₀₀	.630 ⁺⁰⁰² / ₊₀₀₀	.875 ±.001	\$9.42
TP-011-L	3/4	1	.185	-210	.185 ⁺⁰¹⁰ / ₊₀₀₀	.756 ⁺⁰⁰² / ₊₀₀₀	1.000 ⁺⁰⁰² / ₊₀₀₀	8.47
TP-013-L	7/8	1-1/8	.185	-212	.185 ⁺⁰¹⁰ / ₊₀₀₀	.881 ⁺⁰⁰² / ₊₀₀₀	1.125 ⁺⁰⁰² / ₊₀₀₀	9.42
TP-015-L	1	1-1/4	.185	-214	.185 ⁺⁰¹⁰ / ₊₀₀₀	1.006 ⁺⁰⁰² / ₊₀₀₀	1.250 ⁺⁰⁰² / ₊₀₀₀	9.42
TP-017-L	1-1/8	1-3/8	.185	-216	.185 ⁺⁰¹⁰ / ₊₀₀₀	1.131 ⁺⁰⁰² / ₊₀₀₀	1.375 ⁺⁰⁰² / ₊₀₀₀	9.42
TP-019-L	1-1/4	1-1/2	.185	-218	.185 ⁺⁰¹⁰ / ₊₀₀₀	1.256 ⁺⁰⁰² / ₊₀₀₀	1.500 ⁺⁰⁰² / ₊₀₀₀	8.82
TP-021-L	1-3/8	1-5/8	.185	-220	.185 ⁺⁰¹⁰ / ₊₀₀₀	1.381 ⁺⁰⁰² / ₊₀₀₀	1.625 ⁺⁰⁰² / ₊₀₀₀	9.42
TP-022-L	1-1/2	1-3/4	.185	-222	.185 ⁺⁰¹⁰ / ₊₀₀₀	1.506 ⁺⁰⁰² / ₊₀₀₀	1.750 ⁺⁰⁰² / ₊₀₀₀	9.42
TP-023-L	1-1/2	1-7/8	.28	-325	.280 ⁺⁰¹⁰ / ₊₀₀₀	1.502 ⁺⁰⁰² / ₊₀₀₀	1.875 ⁺⁰⁰² / ₊₀₀₀	9.41
TP-024-L	1-5/8	2	.28	-326	.280 ⁺⁰¹⁰ / ₊₀₀₀	1.627 ⁺⁰⁰² / ₊₀₀₀	2.000 ⁺⁰⁰² / ₊₀₀₀	7.90
TP-025-L	1-3/4	2-1/8	.28	-327	.280 ⁺⁰¹⁰ / ₊₀₀₀	1.752 ⁺⁰⁰² / ₊₀₀₀	2.125 ⁺⁰⁰² / ₊₀₀₀	8.29
TP-026-L	1-7/8	2-1/4	.28	-328	.280 ⁺⁰¹⁰ / ₊₀₀₀	1.877 ⁺⁰⁰² / ₊₀₀₀	2.250 ⁺⁰⁰² / ₊₀₀₀	8.81
TP-027-L	2	2-3/8	.28	-329	.280 ⁺⁰¹⁰ / ₊₀₀₀	2.002 ⁺⁰⁰² / ₊₀₀₀	2.375 ⁺⁰⁰² / ₊₀₀₀	9.25
TP-028-L	2-1/8	2-1/2	.28	-330	.280 ⁺⁰¹⁰ / ₊₀₀₀	2.127 ⁺⁰⁰² / ₊₀₀₀	2.500 ⁺⁰⁰² / ₊₀₀₀	9.77
TP-029-L	2-1/4	2-5/8	.28	-331	.280 ⁺⁰¹⁰ / ₊₀₀₀	2.252 ⁺⁰⁰² / ₊₀₀₀	2.625 ⁺⁰⁰² / ₊₀₀₀	10.62

STYLE TP-L LOCKING PISTON T-SEALS

Part Number	A Nom. ID	B Nom. OD	C Nom. Ht	O-RING DASH NUMBER	D GROOVE WIDTH	H GROOVE DIAMETER	J BORE DIAMETER	List Price
TP-030-L	2-3/8	2-3/4	.28	-332	.280 ⁺⁰¹⁰ / ₊₀₀₀	2.377 ⁺⁰⁰³ / _{-.001}	2.750 ⁺⁰⁰³ / _{-.001}	10.73
TP-031-L	2-1/2	2-7/8	.28	-333	.280 ⁺⁰¹⁰ / ₊₀₀₀	2.502 ⁺⁰⁰³ / _{-.001}	2.875 ⁺⁰⁰³ / _{-.001}	11.13
TP-032-L	2-5/8	3	.28	-334	.280 ⁺⁰¹⁰ / ₊₀₀₀	2.627 ⁺⁰⁰³ / _{-.001}	3.000 ⁺⁰⁰³ / _{-.001}	12.33
TP-033-L	2-3/4	3-1/8	.28	-335	.280 ⁺⁰¹⁰ / ₊₀₀₀	2.752 ⁺⁰⁰³ / _{-.001}	3.125 ⁺⁰⁰³ / _{-.001}	12.04
TP-034-L	2-7/8	3-1/4	.28	-336	.280 ⁺⁰¹⁰ / ₊₀₀₀	2.877 ⁺⁰⁰³ / _{-.001}	3.250 ⁺⁰⁰³ / _{-.001}	13.38
TP-035-L	3-1/8	3-1/2	.28	-338	.280 ⁺⁰¹⁰ / ₊₀₀₀	3.128 ⁺⁰⁰³ / _{-.001}	3.500 ⁺⁰⁰⁴ / ₊₀₀₀	14.70
TP-037-L	3-3/8	3-3/4	.28	-340	.280 ⁺⁰¹⁰ / ₊₀₀₀	3.378 ⁺⁰⁰³ / _{-.001}	3.750 ⁺⁰⁰⁴ / ₊₀₀₀	16.61
TP-039-L	3-5/8	4	.28	-342	.280 ⁺⁰¹⁰ / ₊₀₀₀	3.628 ⁺⁰⁰³ / _{-.001}	4.000 ⁺⁰⁰⁴ / ₊₀₀₀	18.53
TP-041-L	3-7/8	4-1/4	.28	-344	.280 ⁺⁰¹⁰ / ₊₀₀₀	3.878 ⁺⁰⁰³ / _{-.001}	4.250 ⁺⁰⁰⁴ / ₊₀₀₀	21.30
TP-043-L	4-1/8	4-1/2	.28	-346	.280 ⁺⁰¹⁰ / ₊₀₀₀	4.128 ⁺⁰⁰³ / _{-.001}	4.500 ⁺⁰⁰⁴ / ₊₀₀₀	23.00
TP-045-L	4-3/8	4-3/4	.28	-348	.280 ⁺⁰¹⁰ / ₊₀₀₀	4.378 ⁺⁰⁰³ / _{-.001}	4.750 ⁺⁰⁰⁴ / ₊₀₀₀	32.12
TP-047-L	4-5/8	5	.28	-350	.280 ⁺⁰¹⁰ / ₊₀₀₀	4.629 ⁺⁰⁰³ / _{-.001}	5.000 ⁺⁰⁰⁵ / ₊₀₀₁	33.55
TP-049-L	4-3/4	5-1/4	.366	-427	.366 ⁺⁰¹⁰ / ₊₀₀₀	4.774 ⁺⁰⁰³ / _{-.001}	5.250 ⁺⁰⁰⁵ / ₊₀₀₁	36.75
TP-051-L	5	5-1/2	.366	-429	.366 ⁺⁰¹⁰ / ₊₀₀₀	5.024 ⁺⁰⁰³ / _{-.001}	5.500 ⁺⁰⁰⁵ / ₊₀₀₁	40.39
TP-053-L	5-1/4	5-3/4	.366	-431	.366 ⁺⁰¹⁰ / ₊₀₀₀	5.274 ⁺⁰⁰³ / _{-.001}	5.750 ⁺⁰⁰⁵ / ₊₀₀₁	41.28
TP-055-L	5-1/2	6	.366	-433	.366 ⁺⁰¹⁰ / ₊₀₀₀	5.524 ⁺⁰⁰³ / _{-.001}	6.000 ⁺⁰⁰⁵ / ₊₀₀₁	44.55
TP-058-L	6	6-1/2	.366	-437	.366 ⁺⁰¹⁰ / ₊₀₀₀	6.024 ⁺⁰⁰⁴ / _{-.002}	6.500 ⁺⁰⁰⁶ / ₊₀₀₀	45.90
TP-443-WB-L	7-1/2	8	.579	-443	.579 ⁺⁰¹⁰ / ₊₀₀₀	7.524 ⁺⁰⁰⁴ / _{-.002}	8.000 ⁺⁰⁰⁶ / ₊₀₀₀	102.00

STYLE CPS CAPPED PISTON T-SEALS



A heavy duty double-acting assembly, the capped piston T-seal exhibits excellent sealability, extrusion resistance, and wearability. T-seals with "BR" suffix utilize a Bronze Filled PTFE cap instead of the standard Glass Filled PTFE cap.

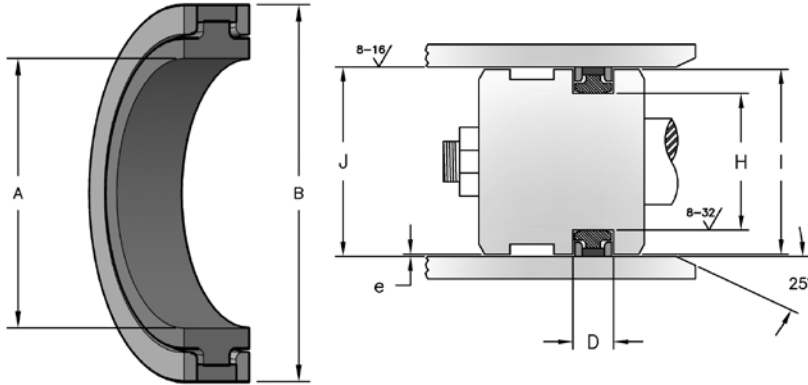

SEAL INFORMATION	
MATERIAL	PTFE CAP NYLON BACK-UP RUBBER ENERGIZER
TEMPERATURE RANGE	-40° TO +220° F
PRESSURE RANGE	0 TO 6,000 psi
SPEED	4.5 FT/SEC
PART NUMBER	(Prefix) - (Bore Size)

Fluorocarbon and H-NBR Capped T-Seals can be manufactured on request for High-Temp and Water Glycol applications.

Part Number	A Nom. ID	B Nom. OD	C Nom. Ht	D GROOVE WIDTH	H GROOVE DIAMETER	I PISTON DIAMETER	I PISTON DIAMETER W/WR	J BORE DIAMETER	List Price
CPS-1750BR	1.376	1-3/4	.424	.424 $\begin{smallmatrix} +.010 \\ +.000 \end{smallmatrix}$	1.376 $\begin{smallmatrix} +.000 \\ -.002 \end{smallmatrix}$	1.749 $\begin{smallmatrix} +.000 \\ -.006 \end{smallmatrix}$	1.749 $\begin{smallmatrix} +.000 \\ -.024 \end{smallmatrix}$	1.750 $\begin{smallmatrix} +.002 \\ +.000 \end{smallmatrix}$	\$60.11
CPS-2000	1.626	2	.424	.424 $\begin{smallmatrix} +.010 \\ +.000 \end{smallmatrix}$	1.626 $\begin{smallmatrix} +.000 \\ -.002 \end{smallmatrix}$	1.999 $\begin{smallmatrix} +.000 \\ -.006 \end{smallmatrix}$	1.999 $\begin{smallmatrix} +.000 \\ -.024 \end{smallmatrix}$	2.000 $\begin{smallmatrix} +.002 \\ +.000 \end{smallmatrix}$	64.48
CPS-2500	2.126	2-1/2	.424	.424 $\begin{smallmatrix} +.010 \\ +.000 \end{smallmatrix}$	2.126 $\begin{smallmatrix} +.000 \\ -.002 \end{smallmatrix}$	2.499 $\begin{smallmatrix} +.000 \\ -.006 \end{smallmatrix}$	2.499 $\begin{smallmatrix} +.000 \\ -.024 \end{smallmatrix}$	2.500 $\begin{smallmatrix} +.002 \\ +.000 \end{smallmatrix}$	67.30
CPS-2750BR	2.376	2-3/4	.424	.424 $\begin{smallmatrix} +.010 \\ +.000 \end{smallmatrix}$	2.376 $\begin{smallmatrix} +.000 \\ -.002 \end{smallmatrix}$	2.749 $\begin{smallmatrix} +.000 \\ -.006 \end{smallmatrix}$	2.749 $\begin{smallmatrix} +.000 \\ -.024 \end{smallmatrix}$	2.750 $\begin{smallmatrix} +.002 \\ +.000 \end{smallmatrix}$	90.99
CPS-3000A	2.442	3	.42	.420 $\begin{smallmatrix} +.010 \\ +.000 \end{smallmatrix}$	2.442 $\begin{smallmatrix} +.000 \\ -.002 \end{smallmatrix}$	2.999 $\begin{smallmatrix} +.000 \\ -.006 \end{smallmatrix}$	2.999 $\begin{smallmatrix} +.000 \\ -.029 \end{smallmatrix}$	3.000 $\begin{smallmatrix} +.003 \\ +.000 \end{smallmatrix}$	40.61
CPS-3000	2.52	3	.579	.579 $\begin{smallmatrix} +.010 \\ +.000 \end{smallmatrix}$	2.520 $\begin{smallmatrix} +.000 \\ -.003 \end{smallmatrix}$	2.999 $\begin{smallmatrix} +.000 \\ -.006 \end{smallmatrix}$	2.999 $\begin{smallmatrix} +.000 \\ -.029 \end{smallmatrix}$	3.000 $\begin{smallmatrix} +.003 \\ +.000 \end{smallmatrix}$	86.87
CPS-3000BR	2.52	3	.579	.579 $\begin{smallmatrix} +.010 \\ +.000 \end{smallmatrix}$	2.520 $\begin{smallmatrix} +.000 \\ -.003 \end{smallmatrix}$	2.999 $\begin{smallmatrix} +.000 \\ -.006 \end{smallmatrix}$	2.999 $\begin{smallmatrix} +.000 \\ -.029 \end{smallmatrix}$	3.000 $\begin{smallmatrix} +.003 \\ +.000 \end{smallmatrix}$	94.31
CPS-3250	2.77	3-1/4	.579	.579 $\begin{smallmatrix} +.010 \\ +.000 \end{smallmatrix}$	2.770 $\begin{smallmatrix} +.000 \\ -.003 \end{smallmatrix}$	3.249 $\begin{smallmatrix} +.000 \\ -.006 \end{smallmatrix}$	3.249 $\begin{smallmatrix} +.000 \\ -.029 \end{smallmatrix}$	3.250 $\begin{smallmatrix} +.003 \\ +.000 \end{smallmatrix}$	89.72
CPS-3500A	2-15/16	3-1/2	.4	.433 $\begin{smallmatrix} +.010 \\ +.000 \end{smallmatrix}$	2.937 $\pm .003$	3.499 $\begin{smallmatrix} +.000 \\ -.006 \end{smallmatrix}$	3.499 $\begin{smallmatrix} +.000 \\ -.029 \end{smallmatrix}$	3.500 $\begin{smallmatrix} +.003 \\ +.000 \end{smallmatrix}$	92.12
CPS-3500	3.02	3-1/2	.579	.579 $\begin{smallmatrix} +.010 \\ +.000 \end{smallmatrix}$	3.020 $\begin{smallmatrix} +.000 \\ -.003 \end{smallmatrix}$	3.499 $\begin{smallmatrix} +.000 \\ -.006 \end{smallmatrix}$	3.499 $\begin{smallmatrix} +.000 \\ -.029 \end{smallmatrix}$	3.500 $\begin{smallmatrix} +.003 \\ +.000 \end{smallmatrix}$	90.33
CPS-3500BR	3.02	3-1/2	.579	.579 $\begin{smallmatrix} +.010 \\ +.000 \end{smallmatrix}$	3.020 $\begin{smallmatrix} +.000 \\ -.003 \end{smallmatrix}$	3.499 $\begin{smallmatrix} +.000 \\ -.006 \end{smallmatrix}$	3.499 $\begin{smallmatrix} +.000 \\ -.029 \end{smallmatrix}$	3.500 $\begin{smallmatrix} +.003 \\ +.000 \end{smallmatrix}$	98.12
CPS-3750	3.27	3-3/4	.579	.579 $\begin{smallmatrix} +.010 \\ +.000 \end{smallmatrix}$	3.270 $\begin{smallmatrix} +.000 \\ -.003 \end{smallmatrix}$	3.749 $\begin{smallmatrix} +.000 \\ -.006 \end{smallmatrix}$	3.749 $\begin{smallmatrix} +.000 \\ -.029 \end{smallmatrix}$	3.750 $\begin{smallmatrix} +.003 \\ +.000 \end{smallmatrix}$	91.44
CPS-4001	3.384	4	.271	.288 $\begin{smallmatrix} +.005 \\ +.000 \end{smallmatrix}$	3.384 $\begin{smallmatrix} +.000 \\ -.003 \end{smallmatrix}$	3.999 $\begin{smallmatrix} +.000 \\ -.002 \end{smallmatrix}$	3.999 $\begin{smallmatrix} +.000 \\ -.029 \end{smallmatrix}$	4.000 $\begin{smallmatrix} +.002 \\ +.000 \end{smallmatrix}$	83.33
CPS-4000	3.52	4	.579	.579 $\begin{smallmatrix} +.010 \\ +.000 \end{smallmatrix}$	3.520 $\begin{smallmatrix} +.000 \\ -.003 \end{smallmatrix}$	3.999 $\begin{smallmatrix} +.000 \\ -.006 \end{smallmatrix}$	3.999 $\begin{smallmatrix} +.000 \\ -.029 \end{smallmatrix}$	4.000 $\begin{smallmatrix} +.003 \\ +.000 \end{smallmatrix}$	94.12
CPS-4000BR	3.52	4	.579	.579 $\begin{smallmatrix} +.010 \\ +.000 \end{smallmatrix}$	3.520 $\begin{smallmatrix} +.000 \\ -.003 \end{smallmatrix}$	3.999 $\begin{smallmatrix} +.000 \\ -.006 \end{smallmatrix}$	3.999 $\begin{smallmatrix} +.000 \\ -.029 \end{smallmatrix}$	4.000 $\begin{smallmatrix} +.003 \\ +.000 \end{smallmatrix}$	102.96
CPS-4250	3.77	4-1/4	.579	.579 $\begin{smallmatrix} +.010 \\ +.000 \end{smallmatrix}$	3.770 $\begin{smallmatrix} +.000 \\ -.003 \end{smallmatrix}$	4.249 $\begin{smallmatrix} +.000 \\ -.006 \end{smallmatrix}$	4.249 $\begin{smallmatrix} +.000 \\ -.029 \end{smallmatrix}$	4.250 $\begin{smallmatrix} +.003 \\ +.000 \end{smallmatrix}$	98.34
CPS-4500	4.02	4-1/2	.579	.579 $\begin{smallmatrix} +.010 \\ +.000 \end{smallmatrix}$	4.020 $\begin{smallmatrix} +.000 \\ -.003 \end{smallmatrix}$	4.499 $\begin{smallmatrix} +.000 \\ -.007 \end{smallmatrix}$	4.499 $\begin{smallmatrix} +.000 \\ -.029 \end{smallmatrix}$	4.500 $\begin{smallmatrix} +.003 \\ +.000 \end{smallmatrix}$	100.49
CPS-4500BR	4.02	4-1/2	.579	.579 $\begin{smallmatrix} +.010 \\ +.000 \end{smallmatrix}$	4.020 $\begin{smallmatrix} +.000 \\ -.003 \end{smallmatrix}$	4.499 $\begin{smallmatrix} +.000 \\ -.007 \end{smallmatrix}$	4.499 $\begin{smallmatrix} +.000 \\ -.029 \end{smallmatrix}$	4.500 $\begin{smallmatrix} +.003 \\ +.000 \end{smallmatrix}$	105.42
CPS-5000A	4.316	5	.268	.268 $\begin{smallmatrix} +.010 \\ +.000 \end{smallmatrix}$	4.316 $\begin{smallmatrix} +.000 \\ -.003 \end{smallmatrix}$	4.999 $\begin{smallmatrix} +.000 \\ -.008 \end{smallmatrix}$	4.999 $\begin{smallmatrix} +.000 \\ -.029 \end{smallmatrix}$	5.000 $\begin{smallmatrix} +.003 \\ +.000 \end{smallmatrix}$	126.98

STYLE CPS CAPPED PISTON T-SEALS

Part Number	A Nom. ID	B Nom. OD	C Nom. Ht	D GROOVE WIDTH	H GROOVE DIAMETER	I PISTON DIAMETER	I PISTON DIAMETER W/WR	J BORE DIAMETER	List Price
CPS-5000	4.27	5	3/4	.750 ^{+0.010} / _{+0.000}	4.270 ^{+0.000} / _{-0.004}	4.999 ^{+0.000} / _{-0.008}	4.999 ^{+0.000} / _{-0.029}	5.000 ^{+0.004} / _{+0.000}	126.36
CPS-5000BR	4.27	5	3/4	.750 ^{+0.010} / _{+0.000}	4.270 ^{+0.000} / _{-0.004}	4.999 ^{+0.000} / _{-0.008}	4.999 ^{+0.000} / _{-0.029}	5.000 ^{+0.004} / _{+0.000}	127.60
CPS-5250	4.52	5-1/4	3/4	.750 ^{+0.010} / _{+0.000}	4.520 ^{+0.000} / _{-0.004}	5.249 ^{+0.000} / _{-0.008}	5.249 ^{+0.000} / _{-0.029}	5.250 ^{+0.004} / _{+0.000}	132.60
CPS-5504BR	5.02	5-1/2	.579	.579 ^{+0.010} / _{+0.000}	5.020 ^{+0.000} / _{-0.004}	5.499 ^{+0.000} / _{-0.008}	5.499 ^{+0.000} / _{-0.029}	5.500 ^{+0.004} / _{+0.000}	136.88
CPS-5500	4.77	5-1/2	3/4	.750 ^{+0.010} / _{+0.000}	4.770 ^{+0.000} / _{-0.004}	5.499 ^{+0.000} / _{-0.008}	5.499 ^{+0.000} / _{-0.029}	5.500 ^{+0.004} / _{+0.000}	140.99
CPS-5500BR	4.77	5-1/2	3/4	.750 ^{+0.010} / _{+0.000}	4.770 ^{+0.000} / _{-0.004}	5.499 ^{+0.000} / _{-0.008}	5.499 ^{+0.000} / _{-0.029}	5.500 ^{+0.004} / _{+0.000}	149.87
CPS-6000A	5.52	6	.579	.579 ^{+0.010} / _{+0.000}	5.520 ^{+0.000} / _{-0.003}	5.999 ^{+0.000} / _{-0.008}	5.999 ^{+0.000} / _{-0.029}	6.000 ^{+0.003} / _{+0.000}	174.94
CPS-6000	5.27	6	3/4	.750 ^{+0.010} / _{+0.000}	5.270 ^{+0.000} / _{-0.004}	5.999 ^{+0.000} / _{-0.008}	5.999 ^{+0.000} / _{-0.029}	6.000 ^{+0.004} / _{+0.000}	144.93
CPS-6015	5.285	6.015	3/4	.750 ^{+0.010} / _{+0.000}	5.285 ^{+0.000} / _{-0.004}	6.014 ^{+0.000} / _{-0.008}	6.014 ^{+0.000} / _{-0.029}	6.015 ^{+0.004} / _{+0.000}	206.58
CPS-6250	5.52	6-1/4	3/4	.750 ^{+0.010} / _{+0.000}	5.520 ^{+0.000} / _{-0.004}	6.249 ^{+0.000} / _{-0.008}	6.249 ^{+0.000} / _{-0.029}	6.250 ^{+0.004} / _{+0.000}	147.80
CPS-6250BR	5.52	6-1/4	3/4	.750 ^{+0.010} / _{+0.000}	5.520 ^{+0.000} / _{-0.004}	6.249 ^{+0.000} / _{-0.008}	6.249 ^{+0.000} / _{-0.029}	6.250 ^{+0.004} / _{+0.000}	153.12
CPS-6504	6.02	6-1/2	.579	.579 ^{+0.010} / _{+0.000}	6.020 ^{+0.000} / _{-0.004}	6.499 ^{+0.000} / _{-0.008}	6.499 ^{+0.000} / _{-0.029}	6.500 ^{+0.004} / _{+0.000}	156.96
CPS-6504BR	6.02	6-1/2	.579	.579 ^{+0.010} / _{+0.000}	6.020 ^{+0.000} / _{-0.004}	6.499 ^{+0.000} / _{-0.008}	6.499 ^{+0.000} / _{-0.029}	6.500 ^{+0.004} / _{+0.000}	167.13
CPS-6500	5.77	6-1/2	3/4	.750 ^{+0.010} / _{+0.000}	5.770 ^{+0.000} / _{-0.004}	6.499 ^{+0.000} / _{-0.008}	6.499 ^{+0.000} / _{-0.029}	6.500 ^{+0.004} / _{+0.000}	146.79
CPS-7000	6.27	7	3/4	.750 ^{+0.010} / _{+0.000}	6.270 ^{+0.000} / _{-0.004}	6.999 ^{+0.000} / _{-0.008}	6.999 ^{+0.000} / _{-0.029}	7.000 ^{+0.004} / _{+0.000}	188.40
CPS-7000BR	6.27	7	3/4	.750 ^{+0.010} / _{+0.000}	6.270 ^{+0.000} / _{-0.004}	6.999 ^{+0.000} / _{-0.008}	6.999 ^{+0.000} / _{-0.029}	7.000 ^{+0.004} / _{+0.000}	191.29
CPS-7250BR	6.52	7-1/4	3/4	.750 ^{+0.010} / _{+0.000}	6.520 ^{+0.000} / _{-0.004}	7.249 ^{+0.000} / _{-0.008}	7.249 ^{+0.000} / _{-0.029}	7.250 ^{+0.004} / _{+0.000}	197.02
CPS-7500	6.77	7-1/2	3/4	.750 ^{+0.010} / _{+0.000}	6.770 ^{+0.000} / _{-0.004}	7.499 ^{+0.000} / _{-0.008}	7.499 ^{+0.000} / _{-0.029}	7.500 ^{+0.004} / _{+0.000}	169.08
CPS-8000	7.27	8	3/4	.750 ^{+0.010} / _{+0.000}	7.270 ^{+0.000} / _{-0.004}	7.999 ^{+0.000} / _{-0.008}	7.999 ^{+0.000} / _{-0.029}	8.000 ^{+0.004} / _{+0.000}	214.28
CPS-8500	7.77	8-1/2	3/4	.750 ^{+0.010} / _{+0.000}	7.770 ^{+0.000} / _{-0.004}	8.499 ^{+0.000} / _{-0.008}	8.499 ^{+0.000} / _{-0.029}	8.500 ^{+0.004} / _{+0.000}	220.90
CPS-9000	8.27	9	3/4	.750 ^{+0.010} / _{+0.000}	8.270 ^{+0.000} / _{-0.004}	8.999 ^{+0.000} / _{-0.008}	8.999 ^{+0.000} / _{-0.029}	9.000 ^{+0.004} / _{+0.000}	234.13
CPS-10000	9.27	10	3/4	.750 ^{+0.010} / _{+0.000}	9.270 ^{+0.000} / _{-0.004}	9.999 ^{+0.000} / _{-0.008}	9.999 ^{+0.000} / _{-0.029}	10.000 ^{+0.004} / _{+0.000}	246.93

Seal color may vary.

REPLACEMENT CAPPED PISTON T-SEALS FOR CATERPILLAR EQUIPMENT*

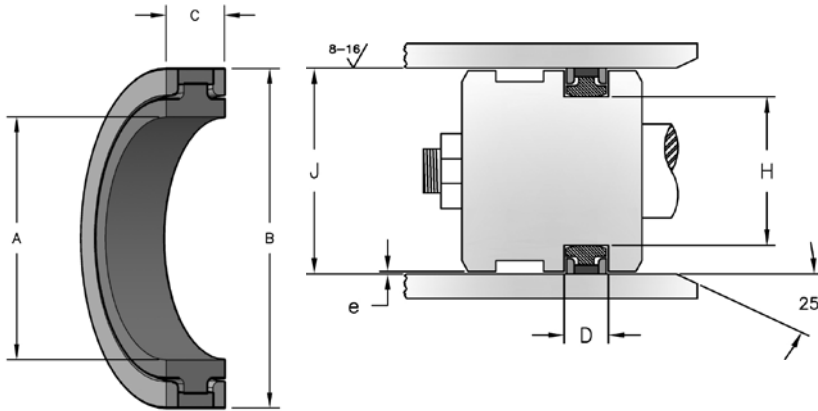

SEAL INFORMATION	
MATERIAL	BUNA-N RUBBER SEAL- HARD PLASTIC BACK-UPS
TEMPERATURE RANGE	-40° TO +220° F
PRESSURE RANGE	0 TO 6,000 PSI

Part Number	A Nom. ID	B Nom. OD	C Nom. Ht	D GROOVE WIDTH	H GROOVE DIAMETER	J BORE DIAMETER	List Price
CTC-8J3747	3.825	4-1/2	1/2	.500 ±.002	3.830 ±.003	4.500	\$105.37
CTC-9J7868	4-1/4	5	5/8	.640 ±.002	4.220 ±.003	5.000	128.75
CTC-8J8767	4-11/16	5-1/2	5/8	.640 ±.002	4.720 ±.003	5.500	144.47
CTC-9J1242	5-1/16	6	5/8	.640 ±.002	5.090 ±.003	6.000	150.95
CTC-9J5558	5-5/16	6-1/4	5/8	.640 ±.002	5.340 ±.003	6.250	154.18
CTC-8J8703	5.5925	6-1/2	5/8	.640 ±.002	5.590 ±.003	6.500	170.11
CTC-8J3749	6-1/16	7	5/8	.640 ±.002	6.090 ±.003	7.000	175.40
CTC-8J4510	6-3/8	7-1/4	5/8	.640 ±.002	6.340 ±.003	7.250	181.10
CTC-9J5567	6-9/16	7-1/2	5/8	.640 ±.002	6.590 ±.003	7.500	183.65
CTC-8J5644	6-13/16	7-3/4	5/8	.640 ±.002	6.840 ±.003	7.750	191.33
CTC-8J4390	7-1/4	8-1/4	5/8	.640 ±.002	7.260 ±.003	8.250	204.11
CTC-3G4762	7-1/2	8-1/2	5/8	.640 ±.002	7.500 ±.003	8.500	214.10
CTC-9J3406	8-7/8	10	11/16	.690 ±.002	8.880 ±.003	10.000	253.99
CTC-3G4765	9-3/8	10-1/2	11/16	.690 ±.002	9.380 ±.003	10.500	274.32
CTC-9J2987	10-3/8	11-1/2	11/16	.690 ±.002	10.380 ±.003	11.500	312.24

INSTALLATION OF PTFE PISTON SEALS

Installing PTFE piston seals is not always an easy task. The use of installation tools is recommended but often not convenient when working with a wide variety of sizes and applications. Finger installations are practical with rings of smaller cross-sections. Using fingers or a rounded plastic stick, knead the ring over the piston into the groove. With rings of larger cross-sections it may be necessary to heat the ring. Warming the ring in water or oil at 130° F or 140° F for about 5 minutes will soften the material for easier installation. Always avoid inconsistent stretching or overstretching of the PTFE seal.

To prevent the PTFE ring from snapping into the wrong groove, cover wear ring grooves with plastic tape.

After seal installation, assembly of the cylinder may be difficult if the piston seal is loose on the piston or the cylinder has an inadequate leading edge chamfer. In such cases, compress the piston seal with belting or a suitable hose clamp. If the piston seal must pass threads or any other sharp edges during the cylinder assembly, cover the edges with plastic tape or wrap.

NOTE: Caterpillar® part numbers are used as a reference only. We do not imply that these parts are original equipment parts.

Seal color may vary.